

# Ultra Slim-Q H120mm

## Modul Box Assembly Instruction

### Special Features:

- Length:270,300,350,400,450,500,550mm.
- The drawer side-board is 120mm high.
- Drawer width can be designed freely with automatic error adjustment.
- Hidden full pullout silencing sliding skid can bear 30kg and enjoys
- excellent stability and quite and smooth sliding performance.
- Quick installation and dismantle.
- Newly-designed built-in damper is free from reinstallation and ensures soft and smooth drawer movements.

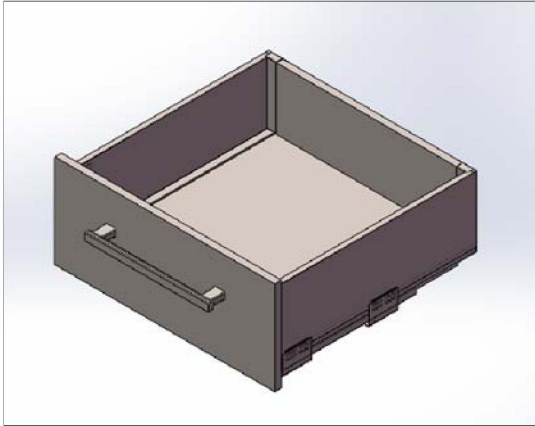

Basic length	Internally usable drawer depth	Minimum installation depth of drawer	Minimum installation height
270mm	244mm	270mm	143mm
300mm	274mm	300mm	143mm
350mm	324mm	350mm	143mm
400mm	374mm	400mm	143mm
450mm	424mm	450mm	143mm
500mm	474mm	500mm	143mm
550mm	524mm	550mm	143mm

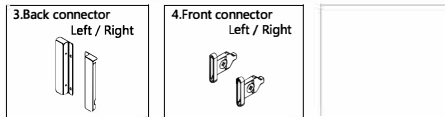
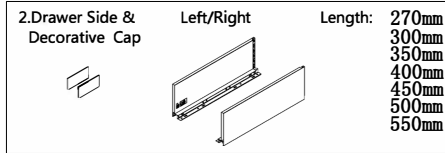
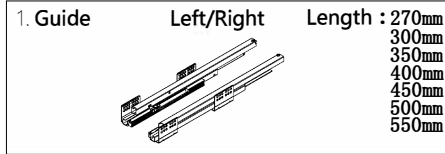
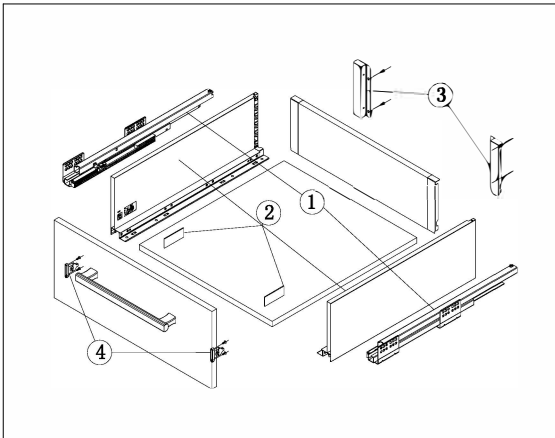

### Technology pivot: Bottom and Back Panel Measurement 16MM Density Panel

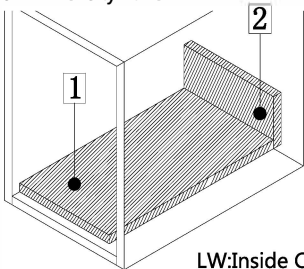

LW:Inside Cabinet Width

- 1 Bottom panel width=Inside Cabinet Width-75±0.5  
Bottom panel length=Runner length-24MM
- 2 Back panel height= 116MM  
Back panel width=Inside Cabinet Width-87±0.5

### Runner Installation(mm)

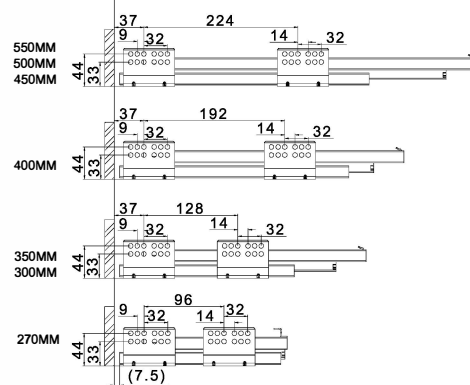

### Inside Cabinet Dimension

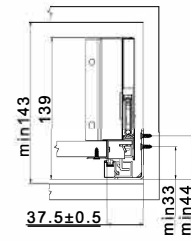

### Front Panel Mounting Positions

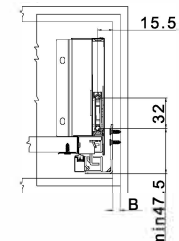

B Side overlay(user-defined)

### Front Fixing Brackets Positions

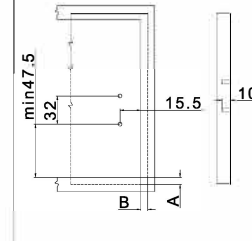

A.B Side overlay(user-defined)

### Back Panel Mounting Positions

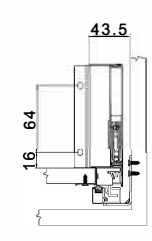

### Front fixing brackets mounting

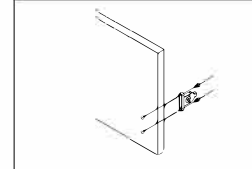

Front panel height adjustment : ±2mm

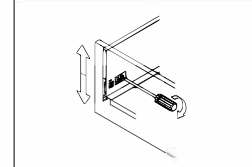

1 Tighten the fixing screw after instilled the panel

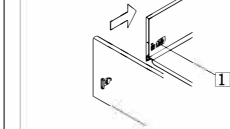

Front panel side adjustment : right1mm

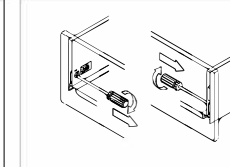

1 Take out the plastic cover

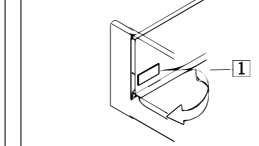

Front panel side adjustment : left1mm

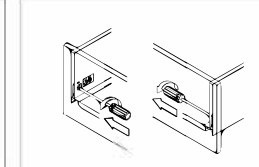

1 Loosen the fastening screws  
2 Rotation to dismantle the panel

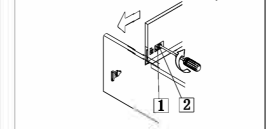

### Mounting the drawer

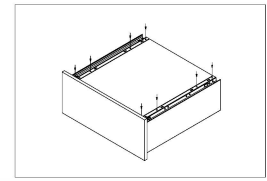
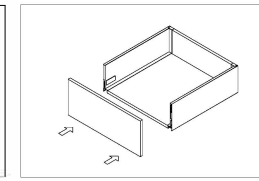
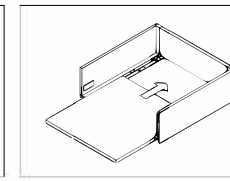
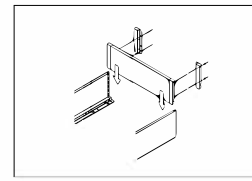

### Installing the drawer

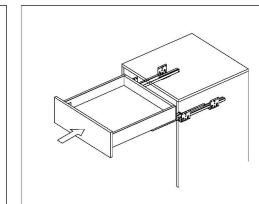
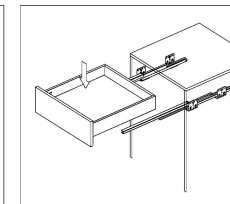
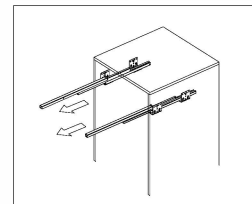

### Removing the drawer

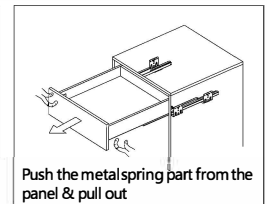

Push the metalspring part from the panel & pull out

### Function of the damper

