

Ultra Slim-Q H203mm

Modul Box Assembly Instruction

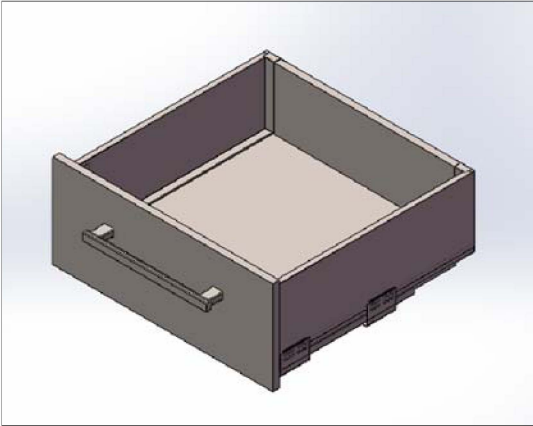

Special Features:

- Length: 270, 300, 350, 400, 450, 500, 550mm.
- The drawer side-board is 203mm high.
- Drawer width can be designed freely with automatic error adjustment.
- Hidden full pullout silencing sliding skid can bear 30kg and enjoys Quick installation and dismantle.
- excellent stability and quite and smooth sliding performance.
- Newly-designed built-in damper is free from reinstallation and ensures soft and smooth drawer movements.

| Basic length | Internally usable drawer depth | Minimum installation depth of drawer | Minimum installation height |
|--------------|--------------------------------|--------------------------------------|-----------------------------|
| 270mm | 244mm | 270mm | 226mm |
| 300mm | 274mm | 300mm | 226mm |
| 350mm | 324mm | 350mm | 226mm |
| 400mm | 374mm | 400mm | 226mm |
| 450mm | 424mm | 450mm | 226mm |
| 500mm | 474mm | 500mm | 226mm |
| 550mm | 524mm | 550mm | 226mm |

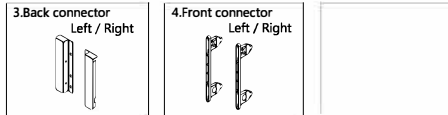
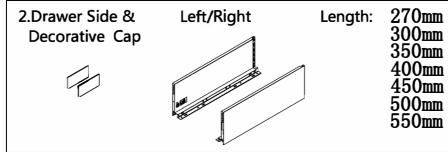
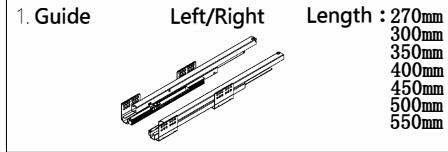
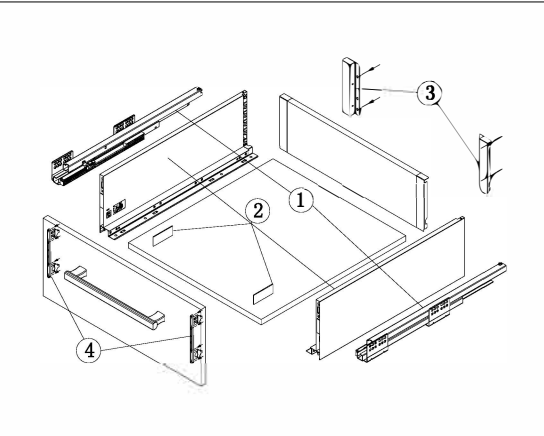

Technology pivot: Bottom and Back Panel Measurement 16MM Density Panel

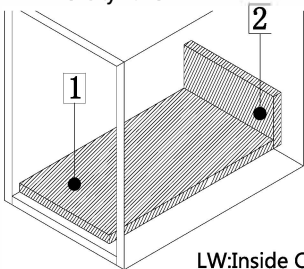

LW: Inside Cabinet Width

- 1 Bottom panel width=Inside Cabinet Width-75±0.5
Bottom panel length=Runner length-24MM
- 2 Back panel height= 199MM
Back panel width=Inside Cabinet Width-87±0.5

Runner Installation(mm)

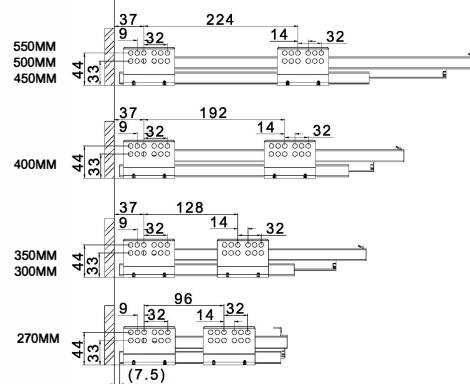

Basic length: 270/300/350/400/450/500/550

Inside Cabinet Dimension

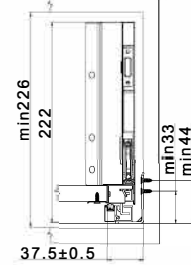

Front Panel Mounting Positions

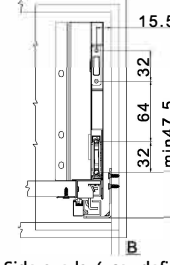

Front Fixing Brackets Positions

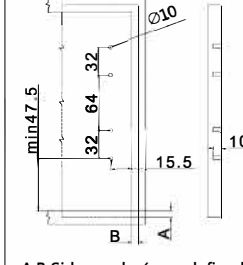

Back Panel Mounting Positions

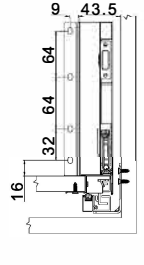

Front fixing brackets mounting

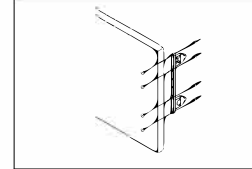

- 1 Tighten the fixing screw after installed the panel

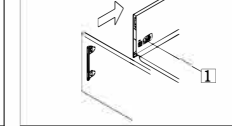

Front panel removing

- 1 Take out the plastic cover

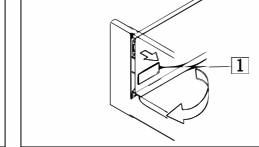

- 1 Loosen the fastening screws
- 2 Rotation to dismantle the panel

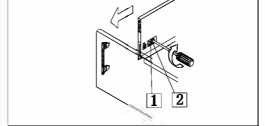

Front panel height adjustment : ±2mm

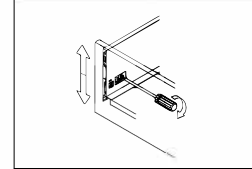

Front panel side adjustment : right 1mm

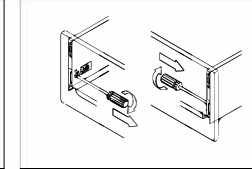

Front panel side adjustment : left 1mm

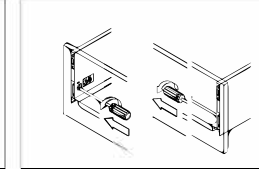

Mounting the drawer

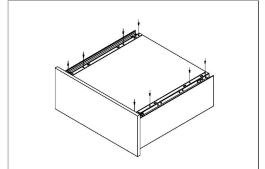
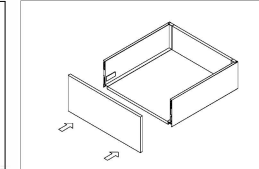
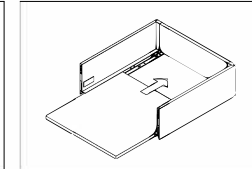
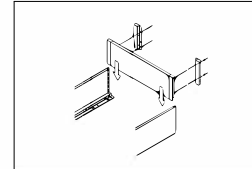

Installing the drawer

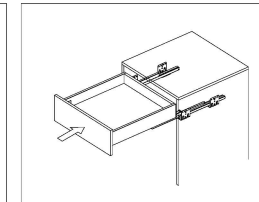
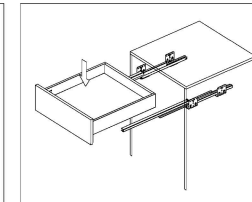
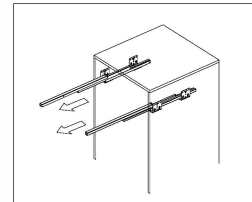

Removing the drawer

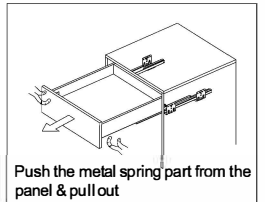

Push the metal spring part from the panel & pull out

Function of the damper

