

# Apex Slim H128mm

## Special Features:

- Length: 300, 350, 400, 450, 500, 550mm.
- The drawer side-board is 128mm high.
- Drawer width can be designed freely with automatic error adjustment.
- Hidden full pullout silencing sliding skid can bear 40kg and enjoys excellent stability and quite and smooth sliding performance.
- Quick installation and dismantle.
- Newly-designed built-in damper is free from reinstallation and ensures soft and smooth drawer movements.

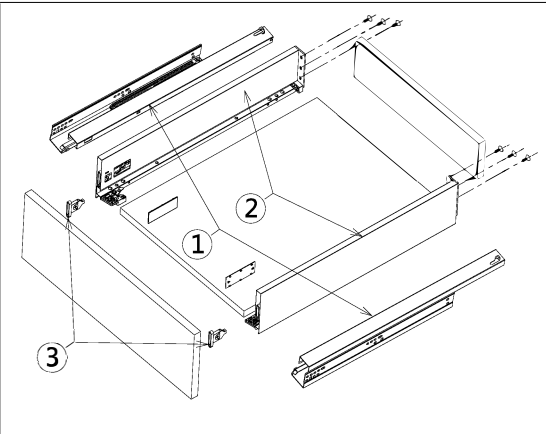
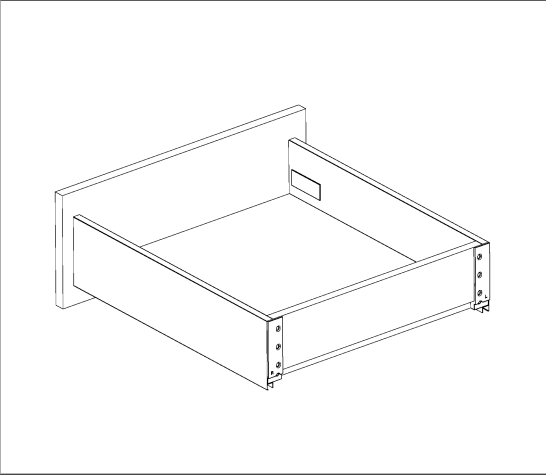

Basic length	Internally usable drawer depth	Minimum installation depth of drawer	Minimum installation height
300mm	272mm	305mm	152mm
350mm	322mm	355mm	152mm
400mm	372mm	405mm	152mm
450mm	422mm	455mm	152mm
500mm	472mm	505mm	152mm
550mm	522mm	555mm	152mm

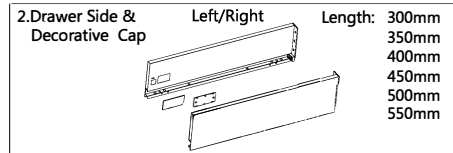
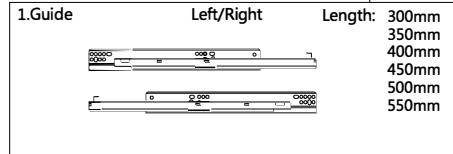

## Technology pivot: Bottom and Back Panel Measurement 16MM Density Panel

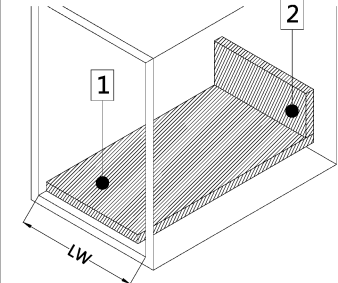

- LW: Inside Cabinet Width
- 1 Bottom panel width = Inside Cabinet Width - 19 ± 0.5
  - 2 Bottom panel length = Runner length - 20mm
  - 3 Back panel height = 101MM
  - 4 Back panel width = Inside Cabinet Width - 42 ± 0.5

## Runner Installation (mm)

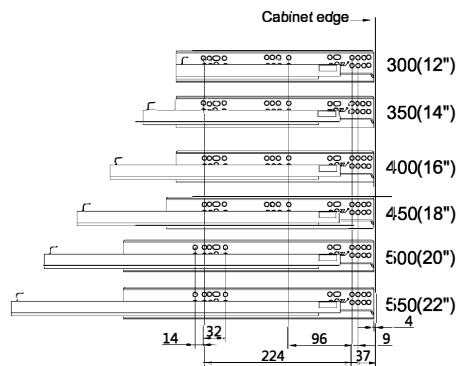

Basic length: 300/350/400/450/500/550mm

# Modul Box Assembly Instruction

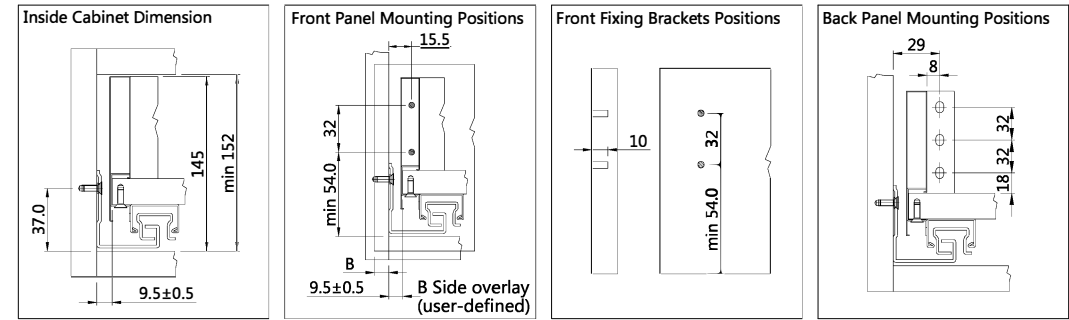

## Front fixing brackets mounting

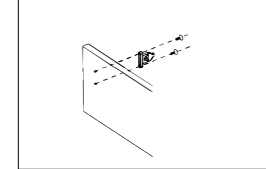

Installed panel  
Remember that tighten the fixing screw

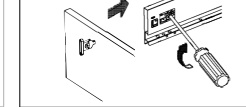

## Front panel removing

Take out the plastic cover

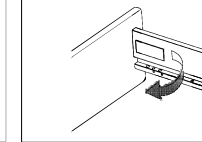

- 1 Loosen the fastening screws
- 2 Rotation to dismantle the panel

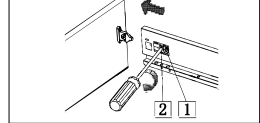

Front panel height adjustment : ±2mm

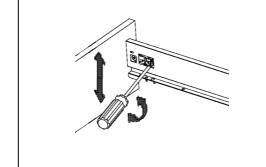

Front panel side adjustment : right 1mm

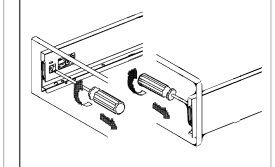

Front panel side adjustment : left 1mm

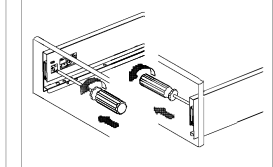

## Mounting the drawer

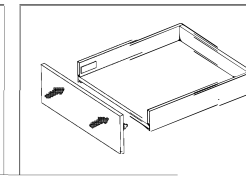
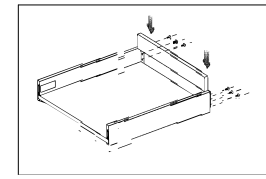
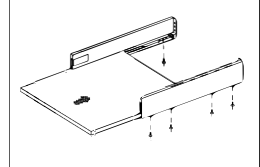

## Clip installation

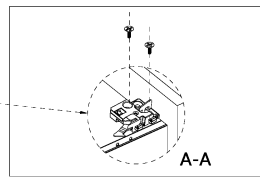
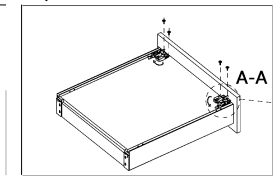

## Installation of drawer

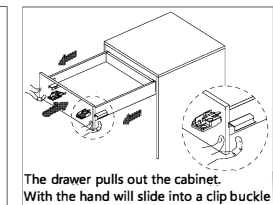
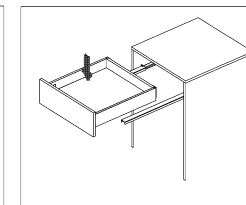
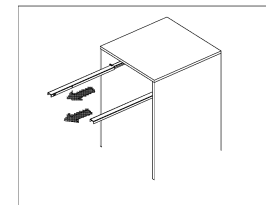

The drawer pulls out the cabinet. With the hand will slide into a clip buckle

## Removing the drawer

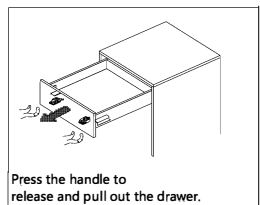

Press the handle to release and pull out the drawer.

## Function of the damper

