

### KickOpen box



- ❑ Integrated with BOTH push open & soft close mechanism
- ❑ Fit the modern handleless cabinet design
- ❑ Easy installation
- ❑ Opening degree : 110°
- ❑ Suitable for cabinet door:
  - Min width 300mm
  - Max width 600mm x 700mm(H) or 600mm x 2700mm(H)
- ❑ Max weight: 7.5kg for short door or 25kg for tall door
- ❑ Opening force: 1-5N
- ❑ Closing force: 4-7N
- ❑ Material : steel , nickel plated



### Order information

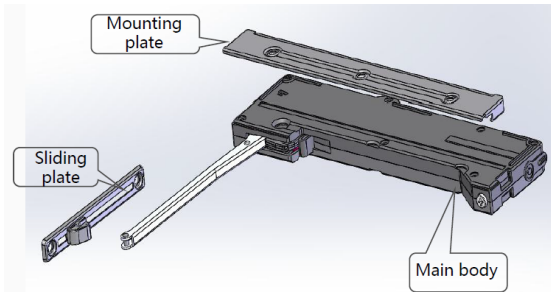

KickOpen system PS1-01



Full overlay hinge WITHOUT string nor damper

### Installation specification

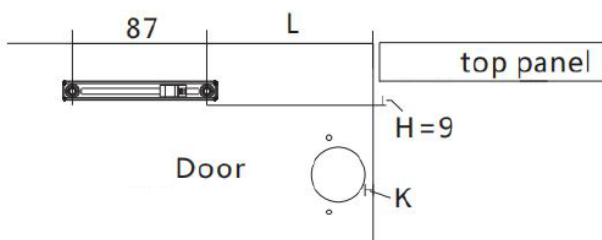

L / 盖位 K值	16	17	18	19	20
3	103	104	105	106	107
4	104	105	106	107	108
5	105	106	107	108	109

### 105 ° Clip on hinge



- ❑ Integrated with soft close mechanism
- ❑ Opening degree : 105°
- ❑ 3D Cam adjustments on arm and mounting plate
- ❑ Two way force to prevent interference with other door
- ❑ For door thickness of 14-22mm
- ❑ Cup diameter : 35mm ; Cup depth : 11.5mm
- ❑ Arm material : Zinc alloy, nickel plated
- ❑ Cup material : Steel, nickel plated

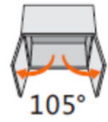

#### Overlay table

Full overlay

(F)

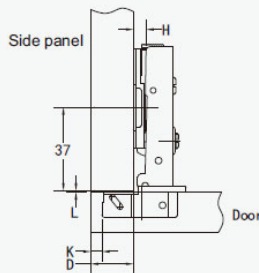

$$H = 14 + K - D$$

D	K	3	4	5	6	7	
H		0	17	18	19	20	21
	2	15	16	17	18	19	
	4	13	14	15	16	17	

Half overlay

(H)

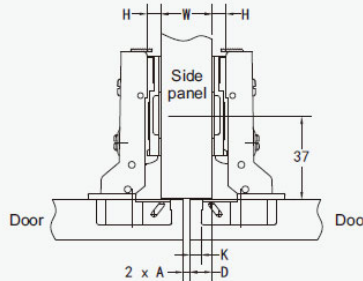

$$H = 4 + K - D$$

D	K	3	4	5	6	7	
H		0	7	8	9	10	11
	2	5	6	7	8	9	
	4	3	4	5	6	7	

Inset

(I)

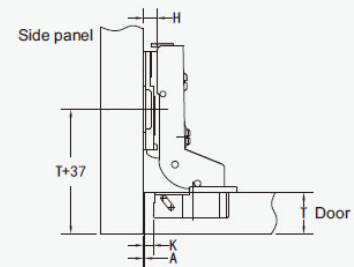

$$H = -4 + K + A$$

D	K	3	4	5	6	7	
H		0	1	0	-1	-2	-3
	2	3	2	1	0	-1	
	4	5	4	3	2	1	

#### Minimum reveal table

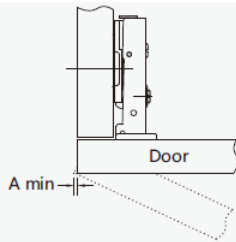

A	T	14	15	16	17	18	19	20	21	22	
K		3	0.3	0.5	0.7	0.9	1.2	1.5	1.8	2.2	2.6
	4	0.3	0.5	0.7	0.9	1.1	1.4	1.8	2.1	2.5	
	5	0.2	0.4	0.6	0.9	1.1	1.4	1.7	2.0	2.4	
	6	0.2	0.4	0.6	0.8	1.1	1.3	1.6	2.0	2.4	
	7	0.2	0.4	0.5	0.8	1.0	1.3	1.6	1.9	2.3	

K = Boring distance

T = Door thickness

A = Minimum gap for door with a door edge radius

L = Gap between door and panel

\* These parameters are based on the door edge with right angle side. If the door has round corner edge, the parameter will be reduced according to the edge size.

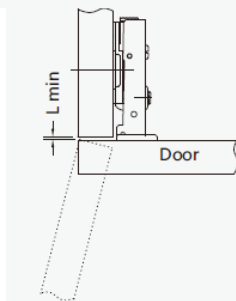

L	T	14	15	16	17	18	19	20	21	22
K		3	1.0	1.0	1.0	1.0	1.0	1.0	1.0	1.0
	4	1.0	1.0	1.0	1.0	1.0	1.0	1.0	1.0	1.2
	5	1.0	1.0	1.0	1.0	1.0	1.3	1.5	1.8	2.0
	6	1.0	1.3	1.5	1.8	2.0	2.3	2.5	2.8	3.0
	7	2.0	2.3	2.5	2.7	3.0	3.2	3.5	3.7	3.9

#### Three-dimensional adjustment

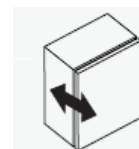

Depth adjustment  
range : 3.8mm

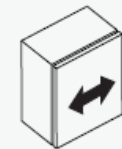

Side adjustment  
range: 3.8mm

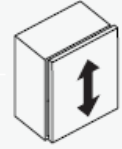

Height adjustment  
range: 3.8mm

# 105 ° Clip on hinge

## Order information

### Drilling hole 45mm CFA105.1

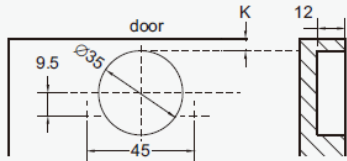

### Drilling hole 48mm CFA105.2

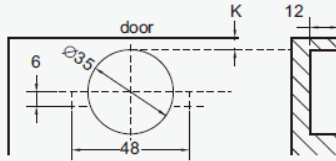

### Drilling hole 52mm CFA105.3

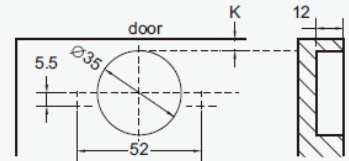

Drilling hole distance	45mm	48mm	52mm
	CFA105.1	CFA105.2	CFA105.3
<b>Full</b>	CFA105.1F. __*	CFA105.2F. __*	CFA105.3F. __*
<b>Half</b>	CFA105.1H. __*	CFA105.2H. __*	CFA105.3H. __*
<b>Inset</b>	CFA105.1I. __*	CFA105.2I. __*	CFA105.3I. __*

Notes \*: \_\_ see below cup installation

## Cup installation

### Screw on

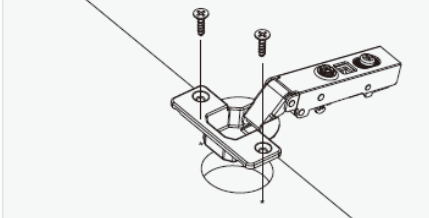

Screw on (wooden screws) .1

Pre-assembled euro screw .2

### Press in

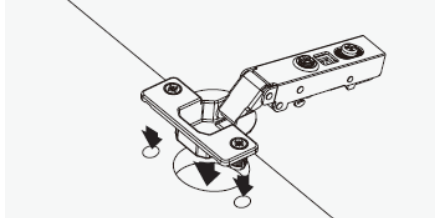

Press in dowels M8 .3

Press in dowels M10 .4

### Expandable dowels

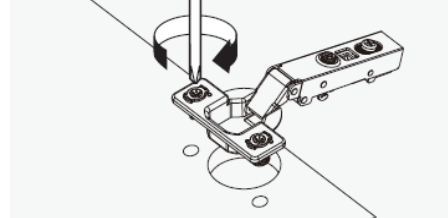

Expandable dowels in 8mm .5

Expandable dowels in 10mm .6

### 165 ° Clip on hinge



- ❑ Integrated with soft close mechanism
- ❑ Opening degree : 165°
- ❑ 3D Cam adjustments on arm and mounting plate
- ❑ For door thickness of 14-26mm
- ❑ Cup diameter : 35mm ; Cup depth : 11.5mm
- ❑ Arm material : Steel/Zinc alloy, nickel plated
- ❑ Cup material : Steel/Zinc alloy, nickel plated

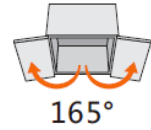

#### Overlay table

Full overlay

(F)

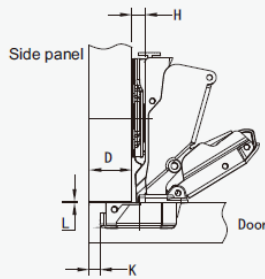

$$H=14+K-D$$

D	K	3	4	5	6	7
H	0	17	18	19	20	21
	2	15	16	17	18	19
	4	13	14	15	16	17

Half overlay

(H)

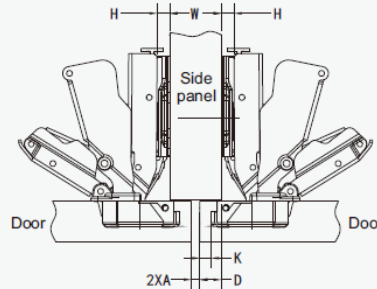

$$H=4+K-D$$

D	K	3	4	5	6	7
H	0	7	8	9	10	11
	2	5	6	7	8	9
	4	3	4	5	6	7

Inset

(I)

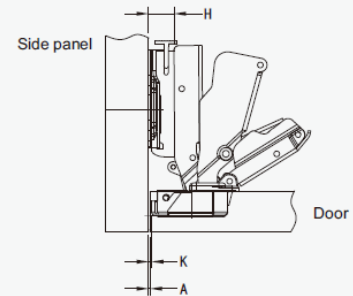

$$H=0+K+A$$

A	K	3	4	5	6	7
H	2	-1	-2	-3	-4	-5
	4	1	0	-1	-2	-3

#### Minimum reveal table

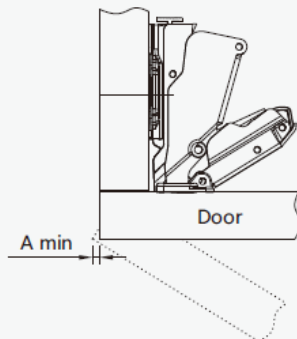

K = Boring distance

T = Door thickness

A = Minimum gap for door with a door edge radius

L = Gap between door and panel

\* These parameters are based on the door edge with right angle side. If the door has round corner edge, the parameter will be reduced according to the edge size.

#### Three-dimensional adjustment

A	T	14	15	16	17	18	19	20	21	22	23	24	25	26
K	3	0.0	0.0	0.0	0.0	0.0	0.0	0.0	0.0	0.5	1.0	1.6	2.1	2.7
	4	0.0	0.0	0.0	0.0	0.0	0.0	0.0	0.0	0.3	0.9	1.4	2.0	2.5
	5	0.0	0.0	0.0	0.0	0.0	0.0	0.0	0.0	0.1	0.7	1.2	1.8	2.3
	6	0.0	0.0	0.0	0.0	0.0	0.0	0.0	0.0	0.0	0.5	1.1	1.6	2.2
	7	0.0	0.0	0.0	0.0	0.0	0.0	0.0	0.0	0.0	0.4	0.9	1.5	2.0

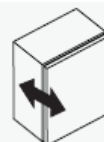

Depth adjustment  
range : 3.8mm



Side adjustment  
range: 5mm

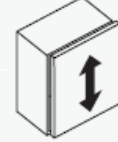

Height adjustment  
range: 3.8mm

# 165 ° Clip on hinge

## Order information

### Drilling hole 45mm CFA165.1

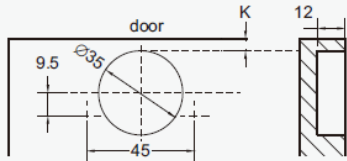

### Drilling hole 48mm CFA165.2

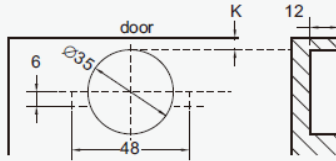

### Drilling hole 52mm CFA165.3

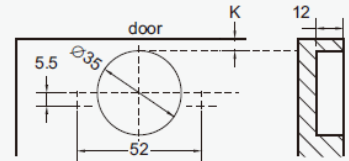

Drilling hole distance	45mm	48mm	52mm
	CFA165.1	CFA165.2	CFA165.3
<b>Full</b>	CFA165.1F. __*	CFA165.2F. __*	CFA165.3F. __*
<b>Half</b>	CFA165.1H. __*	CFA165.2H. __*	CFA165.3H. __*
<b>Inset</b>	CFA165.1I. __*	CFA165.2I. __*	CFA165.3I. __*

Notes \*: \_\_ see below cup installation

## Cup installation

### Screw on

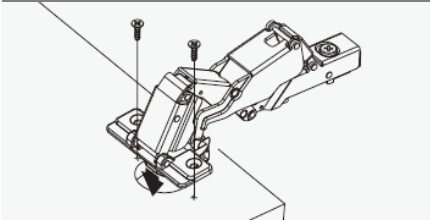

Screw on  
(wooden screws)

.1

### Press in

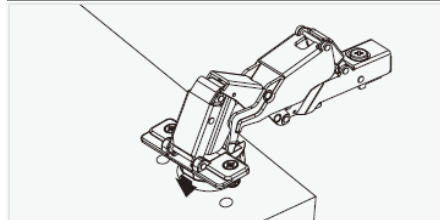

Press in dowels M8

.3

Press in dowels M10

.4

### Expandable dowels

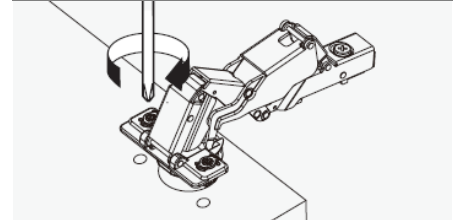

Expandable dowels in  
8mm

.5

Expandable dowels in  
10mm

.6

### 125 ° Clip on hinge



- ❑ Integrated with soft close mechanism
- ❑ Opening degree : 125°
- ❑ 3D Cam adjustments on arm and mounting plate
- ❑ For door thickness of 16-22mm
- ❑ Cup diameter : 35mm ; Cup depth : 12.5mm
- ❑ Arm material : Steel, nickel plated
- ❑ Cup material : Steel, nickel plated

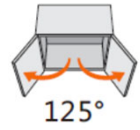

#### Overlay table

Full overlay

(F)

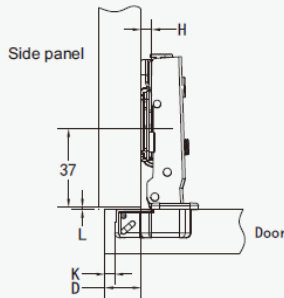

$$H = 14 + K - D$$

D	K	3	4	5	6	7
H	0	17	18	19	20	21
	2	15	16	17	18	19
	4	13	14	15	16	17

Half overlay

(H)

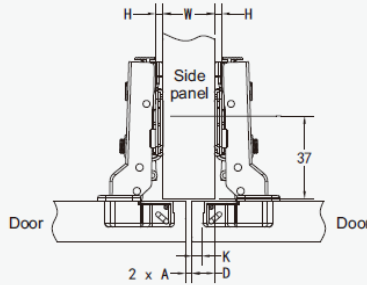

$$H = 4 + K - D$$

D	K	3	4	5	6	7
H	0	7	8	9	10	11
	2	5	6	7	8	9
	4	3	4	5	6	7

#### Minimum reveal table

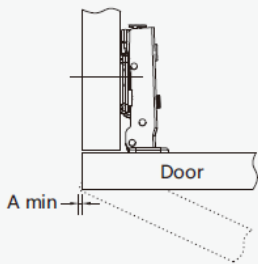

A	T	16	17	18	19	20	21	22
K	3	0.9	1.2	1.7	2.2	2.6	3.0	3.4
	4	0.8	1.2	1.6	2.1	2.5	2.9	3.3
	5	0.7	1.1	1.6	2.0	2.4	2.8	3.2
	6	0.6	1.0	1.5	1.9	2.3	2.7	3.1
	7	0.5	0.9	1.4	1.8	2.2	2.6	3.1

K = Boring distance

T = Door thickness

A = Minimum gap for door with a door edge radius

L = Gap between door and panel

\* These parameters are based on the door edge with right angle side. If the door has round corner edge, the parameter will be reduced according to the edge size.

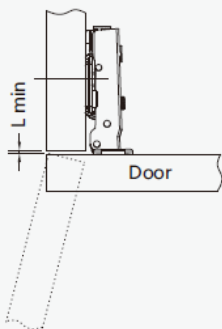

L	T	16	17	18	19	20	21	22
K	3	1.0	1.0	1.0	1.0	1.0	1.3	1.9
	4	1.0	1.0	1.0	1.1	1.6	2.1	2.7
	5	1.0	1.0	1.4	1.9	2.4	3.0	3.5
	6	1.0	1.6	2.2	2.7	3.3	3.8	4.4
	7	1.9	2.5	3.0	3.6	4.1	4.7	5.2

#### Three-dimensional adjustment

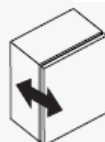

Depth adjustment  
range : 3.8mm

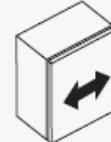

Side adjustment  
range: 5mm

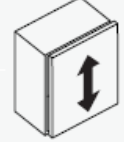

Height adjustment  
range: 3.8mm

# 125 ° Clip on hinge

## Order information

### Drilling hole 45mm CFA125.1

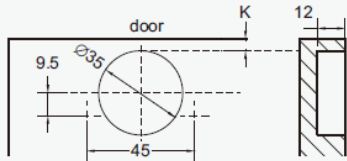

### Drilling hole 48mm CFA125.2

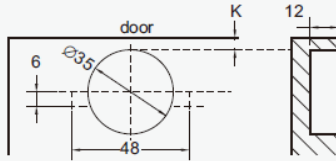

### Drilling hole 52mm CFA125.3

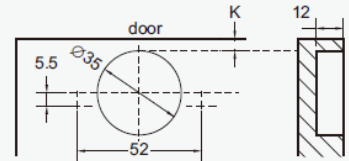

Drilling hole distance	45mm	48mm	52mm
	CFA125.1	CFA125.2	CFA125.3
<b>Full</b>	CFA125.1F. __*	CFA125.2F. __*	CFA125.3F. __*
<b>Half</b>	CFA125.1H. __*	CFA125.2H. __*	CFA125.3H. __*

Notes \*: .\_\_ see below cup installation

## Cup installation

### Screw on

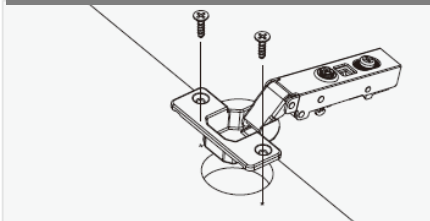

Screw on  
(wooden screws)

.1

### Press in

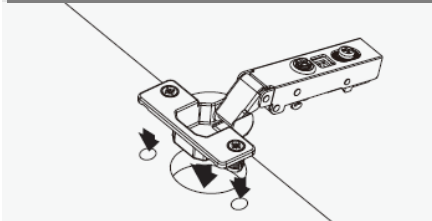

Press in dowels M8

.3

### Expandable dowels

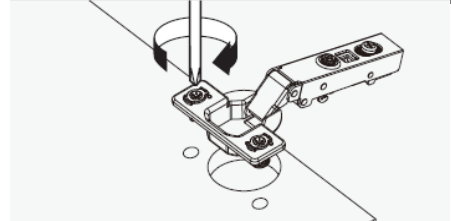

Expandable dowels in  
8mm

.5

Pre-assembled  
euro screw

.2

Press in dowels M10

.4

Expandable dowels in  
10mm

.6

### 155 ° Zero protrusion Clip on hinge



- ❑ Integrated with soft close mechanism
- ❑ Opening degree : 155°
- ❑ 3D Cam adjustments on arm and mounting plate
- ❑ For door thickness of 14-26mm
- ❑ Cup diameter : 35mm ; Cup depth : 11.5mm
- ❑ Arm material : Steel/Zinc alloy, nickel plated
- ❑ Cup material : Steel/Zinc alloy, nickel plated

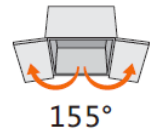

#### Overlay table

**Full overlay (F)**

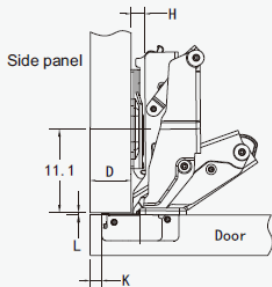

$$H = 14 + K - D$$

D	K	3	4	5	6	7	
H	K	0	17	18	19	20	21
		2	15	16	17	18	19
		4	13	14	15	16	17

**Half overlay (H)**

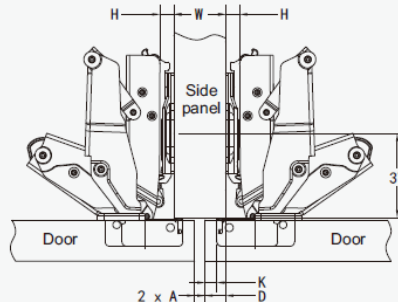

$$H = 4 + K - D$$

D	K	3	4	5	6	7	
H	K	0	7	8	9	10	11
		2	5	6	7	8	9
		4	3	4	5	6	7

**Inset (I)**

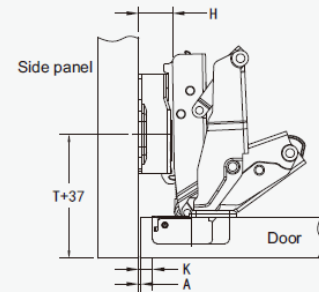

$$H = 5 + K + A$$

A	K	3	4	5	6	7	
H	K	9	1	0	-1	-2	-3

Remark : Inset hinge should use  
2 holes mounting plate H=2

#### Minimum reveal table

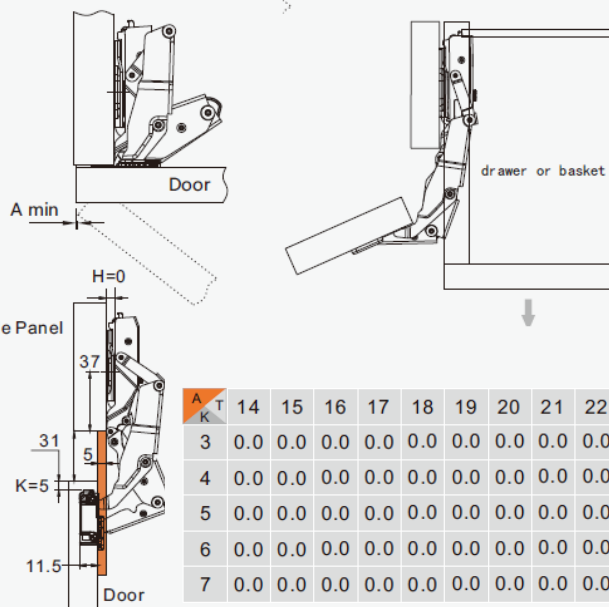

K = Boring distance

T = Door thickness

A = Minimum gap for door with a door edge radius

L = Gap between door and panel

\* These parameters are based on the door edge with right angle side. If the door has round corner edge, the parameter will be reduced according to the edge size.

#### Three-dimensional adjustment

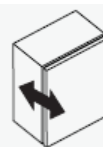

Depth adjustment  
range : 6mm



Side adjustment  
range: 6mm

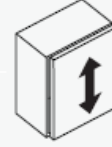

Height adjustment  
range: 3.8mm

\* Notice: The reference adjustment range is the product design range, the actual size of the cabinet and the drilling method may have a certain impact on the parameters.

\*\* Zero Protrusion: When the door is opened parallel to the side panels, if there is a pull basket or drawer inside the cabinet, the door does not protrude to block the internal structure from pulling out.

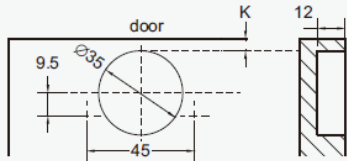
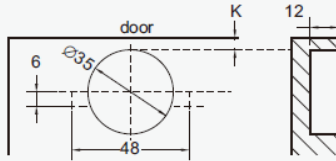
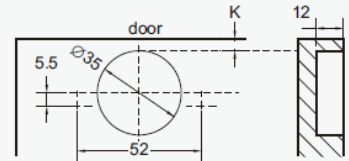

# 155 ° Zero protrusion Clip on hinge

**Order information**
**Drilling hole 45mm CFA155.1**

**Drilling hole 48mm CFA155.2**

**Drilling hole 52mm CFA155.3**

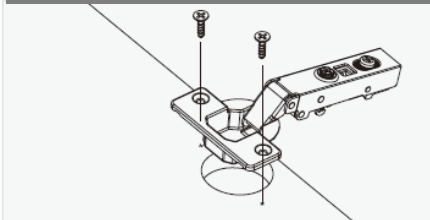
Drilling hole distance	45mm	48mm	52mm
	CFA155.1	CFA155.2	CFA155.3
<b>Full</b>	CFA155.1F. __*	CFA155.2F. __*	CFA155.3F. __*
<b>Half</b>	CFA155.1H. __*	CFA155.2H. __*	CFA155.3H. __*
<b>Inset</b>	CFA155.1I. __*	CFA155.2I. __*	CFA155.3I. __*

Notes \*: \_\_ see below cup installation

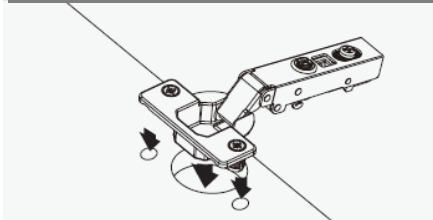
**Cup installation**
**Screw on**

<b>Screw on (wooden screws)</b>	.1
<b>Pre-assembled euro screw</b>	.2

**Press in**

<b>Press in dowels M8</b>	.3
<b>Press in dowels M10</b>	.4

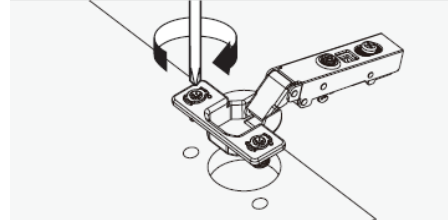
**Expandable dowels**

<b>Expandable dowels in 8mm</b>	.5
<b>Expandable dowels in 10mm</b>	.6

### 135° Bi-fold Clip on hinge



- ❑ Integrated with soft close mechanism
- ❑ Opening degree : 135°
- ❑ 3D Cam adjustments on arm and mounting plate
- ❑ For door thickness of 14-22mm
- ❑ Cup diameter : 35mm ; Cup depth : 11.5mm
- ❑ Arm material : Steel/Zinc alloy, nickel plated
- ❑ Cup material : Steel, nickel plated

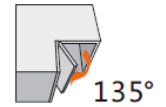

#### Overlay table

##### Full overlay

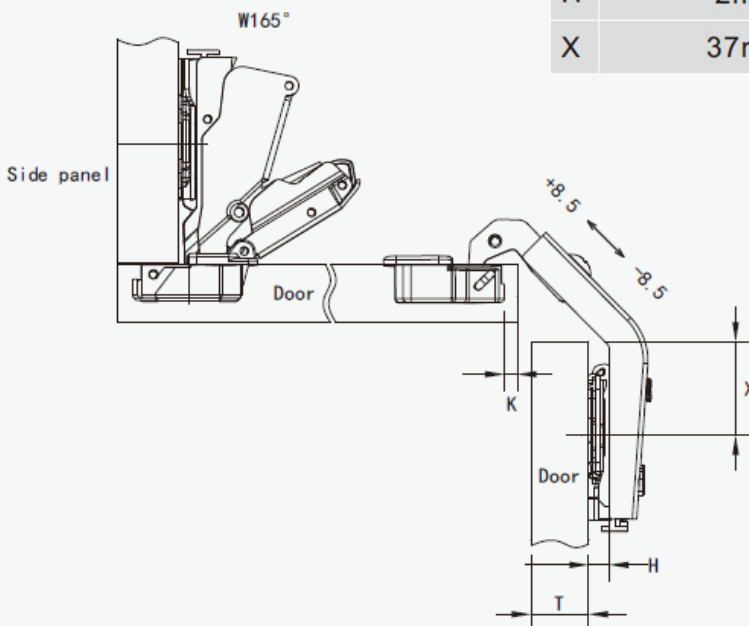

D	Door thickness < 18mm	22mm > Door thickness > 18mm
H	2mm	0mm
X	37mm	37mm

#### Application

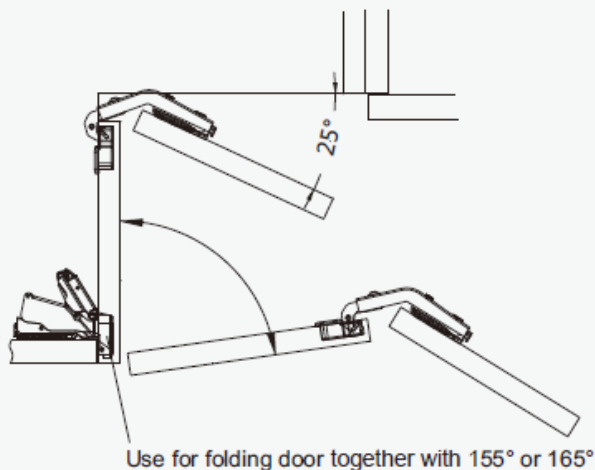

#### Three-dimensional adjustment

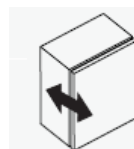

Depth adjustment  
range : 3.8mm

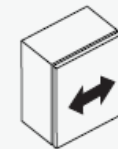

Side adjustment  
range: 5mm

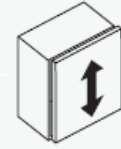

Height adjustment  
range: 3.8mm

# 135° Bi-fold Clip on hinge

## Order information

### Drilling hole 45mm CFA135.1

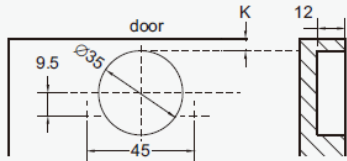

### Drilling hole 48mm CFA135.2

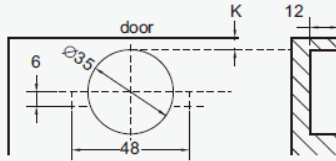

### Drilling hole 52mm CFA135.3

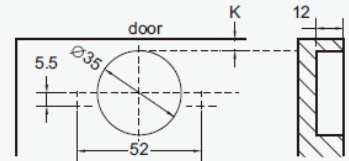

**Drilling hole distance**

**45mm**

**48mm**

**52mm**

**CFA135.1. \_\_\***

**CFA135.2. \_\_\***

**CFA135.3. \_\_\***

Notes \*: .\_\_ see below cup installation

## Cup installation

### Screw on

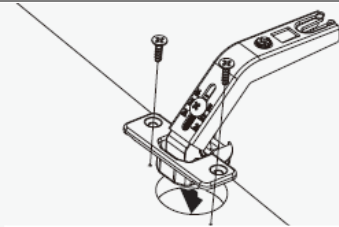

**Screw on (wooden screws)**

.1

### Press in

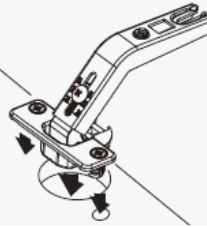

**Press in dowels M8**

.3

### Expandable dowels

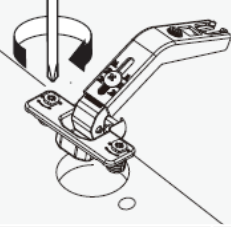

**Expandable dowels in 8mm**

.5

**Pre-assembled euro screw**

.2

**Press in dowels M10**

.4

**Expandable dowels in 10mm**

.6

### 30° Blind corner Clip on hinge



- ❑ Integrated with soft close mechanism
- ❑ Opening degree : 30°
- ❑ 3D Cam adjustments on arm and mounting plate
- ❑ For door thickness of 14-22mm
- ❑ Cup diameter : 35mm ; Cup depth : 11.5mm
- ❑ Arm material : Steel/Zinc alloy, nickel plated
- ❑ Cup material : Steel, nickel plated

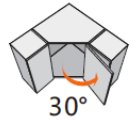

#### Overlay table

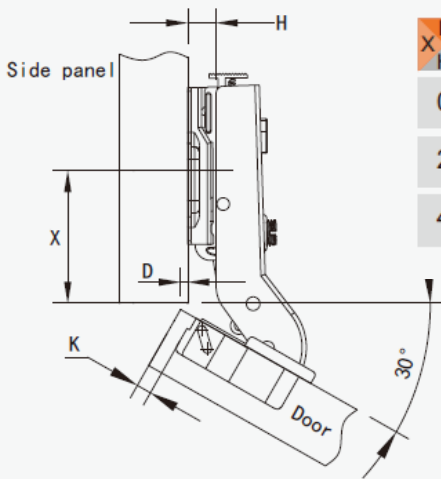

D X H K	4	5	6	7
	0	37 3	36 4	35 5
2	37 1	36 2	35 3	34 4
4	37 -1	36 0	35 1	34 2

#### Three-dimensional adjustment

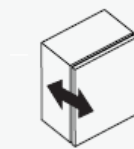

Depth adjustment  
range : 3.8mm

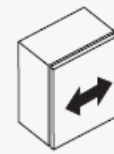

Side adjustment  
range: 5mm

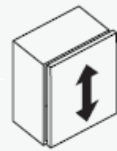

Height adjustment  
range: 3.8mm

#### Application

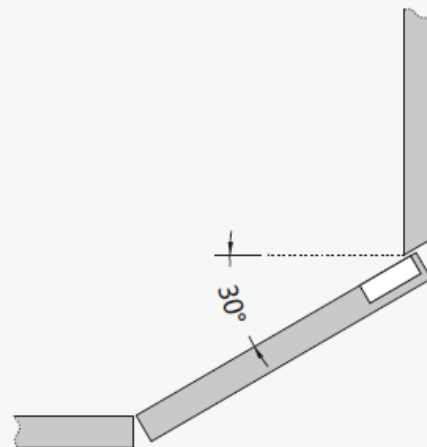
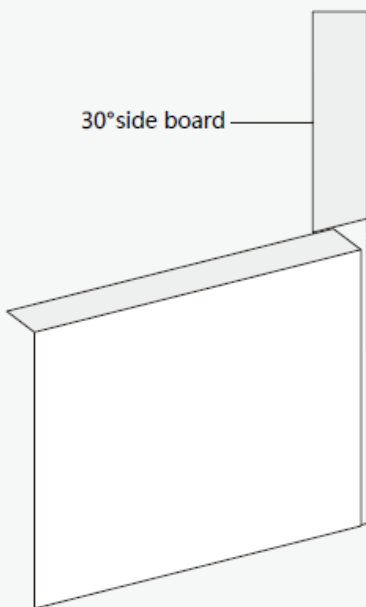

# 30° Blind corner Clip on hinge

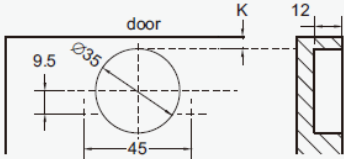
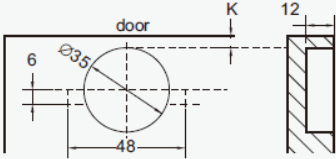
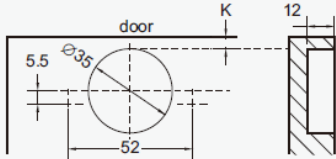
Order information			
Drilling hole 45mm CFA030.1		Drilling hole 48mm CFA030.2	
			
Drilling hole 52mm CFA030.3			
			
Drilling hole distance	45mm	48mm	52mm
	CFA030.1__*	CFA030.2__*	CFA030.3__*

Notes \*: \_\_ see below cup installation

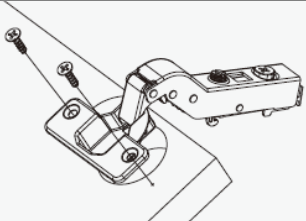
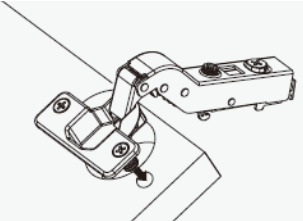
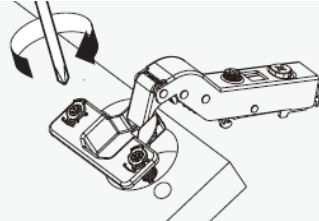
Cup installation					
Screw on		Press in		Expandable dowels	
					
Screw on (wooden screws)	.1	Press in dowels M8	.3	Expandable dowels in 8mm	.5
Pre-assembled euro screw	.2	Press in dowels M10	.4	Expandable dowels in 10mm	.6

### 45° Blind corner Clip on hinge



- ❑ Integrated with soft close mechanism
- ❑ Opening degree : 45°
- ❑ 3D Cam adjustments on arm and mounting plate
- ❑ For door thickness of 14-22mm
- ❑ Cup diameter : 35mm ; Cup depth : 11.5mm
- ❑ Arm material : Steel/Zinc alloy, nickel plated
- ❑ Cup material : Steel, nickel plated

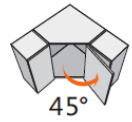

#### Overlay table

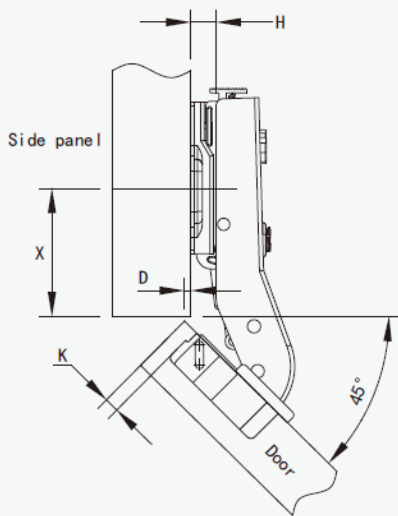

$\begin{matrix} D \\ X \\ H \\ K \end{matrix}$	4	5	6	7
0	37 3	36 4	35 5	34 6
2	37 1	36 2	35 3	34 4
4	37 -1	36 0	35 1	34 2

#### Three-dimensional adjustment

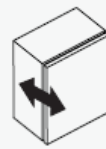

Depth adjustment  
range : 3.8mm

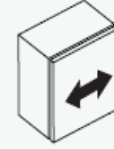

Side adjustment  
range: 5mm

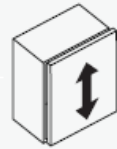

Height adjustment  
range: 3.8mm

#### Application

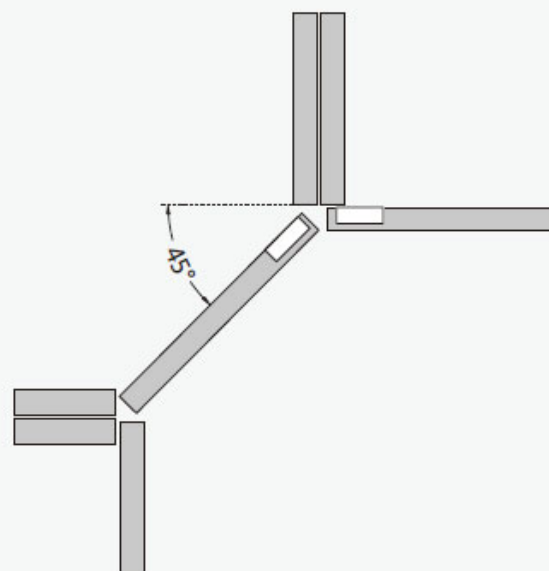
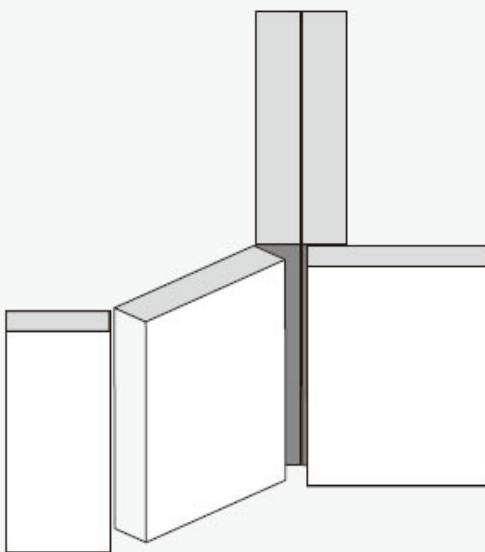

## 45° Blind corner Clip on hinge

### Order information

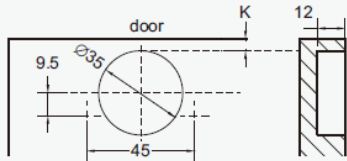
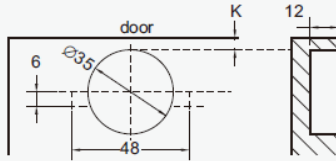
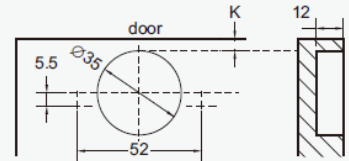
**Drilling hole 45mm CFA030.1**

**Drilling hole 48mm CFA030.2**

**Drilling hole 52mm CFA030.3**

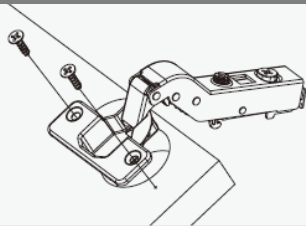
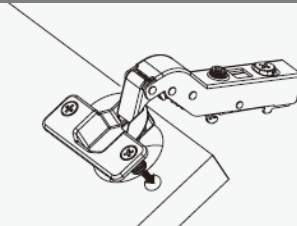
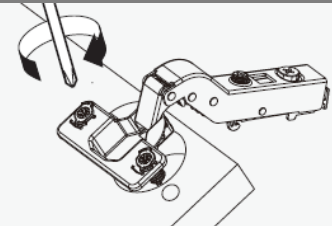
**Drilling hole distance**
**45mm**
**48mm**
**52mm**
**CFA030.1. \_\_\***
**CFA030.2. \_\_\***
**CFA030.3. \_\_\***

Notes \*: .\_\_ see below cup installation

### Cup installation

**Screw on**

**Press in**

**Expandable dowels**

**Screw on  
(wooden screws)**
**.1**
**Press in dowels M8**
**.3**
**Expandable dowels in  
8mm**
**.5**
**Pre-assembled  
euro screw**
**.2**
**Press in dowels M10**
**.4**
**Expandable dowels in  
10mm**
**.6**

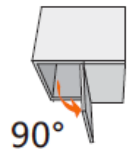
### 90° Bi-fold Clip on hinge



- ❑ Integrated with soft close mechanism
- ❑ Opening degree : 90°
- ❑ 3D Cam adjustments on arm and mounting plate
- ❑ For door thickness of 14-22mm
- ❑ Cup diameter : 35mm ; Cup depth : 11.5mm
- ❑ Arm material : Steel/Zinc alloy, nickel plated
- ❑ Cup material : Steel, nickel plated



#### Overlay table

##### Full overlay

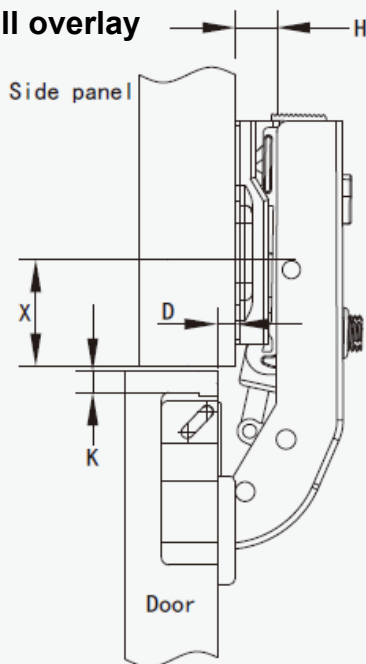

X	D	K	4	5
0	20	3	19	3
2	20	1	19	1
4	20	-1	19	-1

#### Three-dimensional adjustment

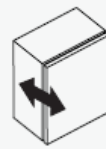

Depth adjustment  
range : 3.8mm

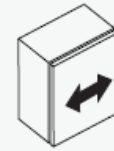

Side adjustment  
range: 5mm

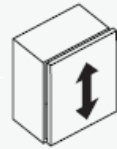

Height adjustment  
range: 3.8mm

\* Can only use with 2 holes clip on plate H=0, 2, 4

#### Application

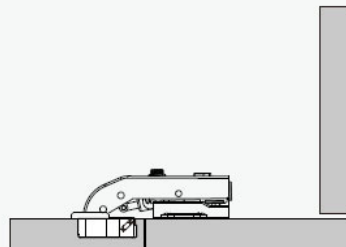
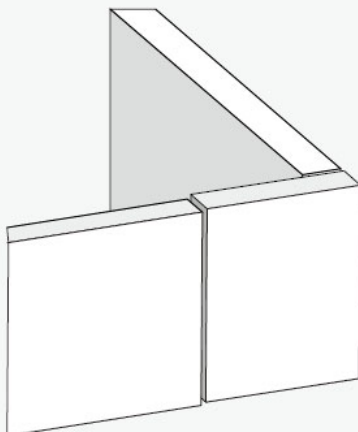



## 90° Bi-fold Clip on hinge

### Order information

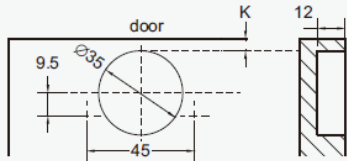
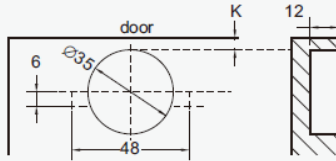
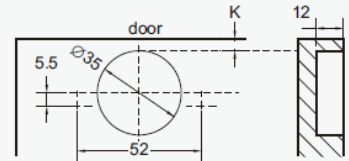
**Drilling hole 45mm CFA090.1**

**Drilling hole 48mm CFA090.2**

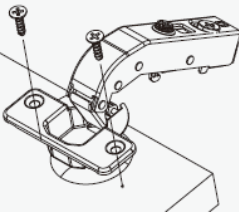
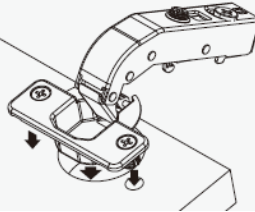
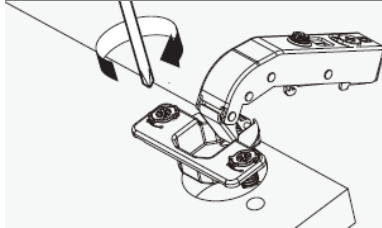
**Drilling hole 52mm CFA090.3**

**Drilling hole distance**
**45mm**
**48mm**
**52mm**
**CFA090.1. \_\_\***
**CFA090.2. \_\_\***
**CFA090.3. \_\_\***
**Notes \*: .\_\_ see below cup installation**

### Cup installation

**Screw on**

**Press in**

**Expandable dowels**

**Screw on  
(wooden screws)**
**.1**
**Press in dowels M8**
**.3**
**Expandable dowels in  
8mm**
**.5**
**Pre-assembled  
euro screw**
**.2**
**Press in dowels M10**
**.4**
**Expandable dowels in  
10mm**
**.6**

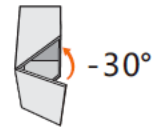
### -30° Bi-fold Clip on hinge



- ❑ Integrated with soft close mechanism
- ❑ Opening degree : -30°
- ❑ 3D Cam adjustments on arm and mounting plate
- ❑ For door thickness of 14-22mm
- ❑ Cup diameter : 35mm ; Cup depth : 11.5mm
- ❑ Arm material : Zinc alloy, nickel plated
- ❑ Cup material : Steel, nickel plated



#### Overlay table

#### Three-dimensional adjustment

(F)

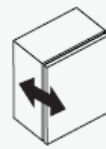
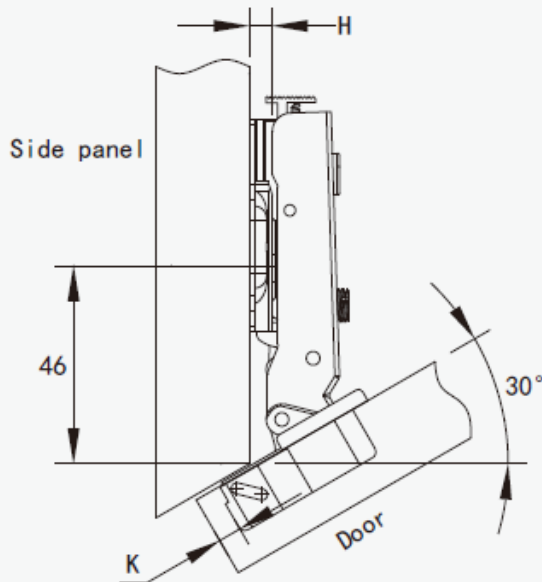

Depth adjustment  
range : 3.8mm



Side adjustment  
range: 5mm

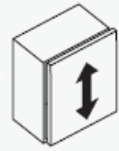

Height adjustment  
range: 3.8mm

#### Application

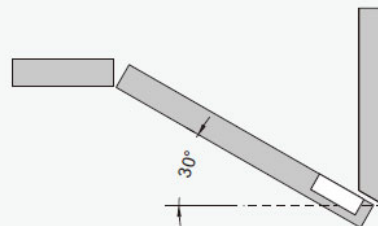
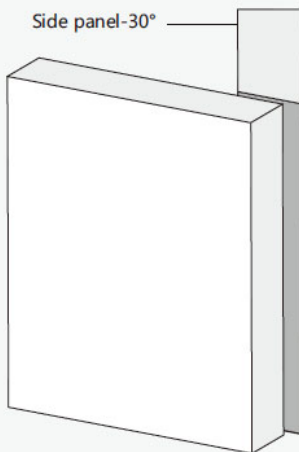

# -30° Bi-fold Clip on hinge

**Order information**

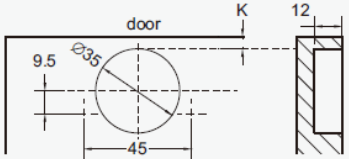
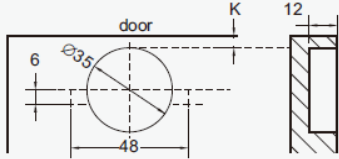
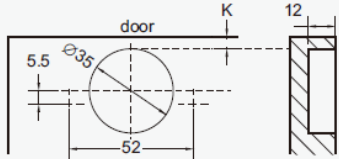
Drilling hole 45mm CFAY90.1		Drilling hole 48mm CFAY90.2		Drilling hole 52mm CFAY90.3	
					
Drilling hole distance	45mm	48mm	52mm		
	CFAY90.1. __*	CFAY90.2. __*	CFAY90.3. __*		

Notes \*: \_\_ see below cup installation

**Cup installation**

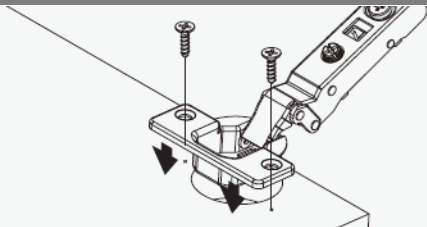
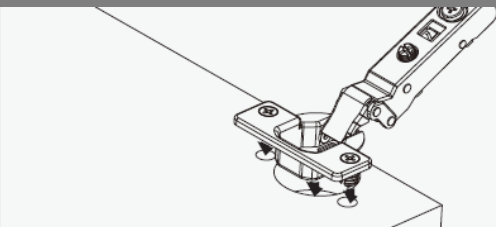
Screw on		Press in	
			
Screw on (wooden screws)	.1	Press in dowels M8	.3
Pre-assembled (ø5mm hole) euro screw	.2	Press in dowels M10	.4

### -45° Bi-fold Clip on hinge



- ❑ Integrated with soft close mechanism
- ❑ Opening degree : -45°
- ❑ 3D Cam adjustments on arm and mounting plate
- ❑ For door thickness of 14-22mm
- ❑ Cup diameter : 35mm ; Cup depth : 11.5mm
- ❑ Arm material : Zinc alloy, nickel plated
- ❑ Cup material : Steel, nickel plated

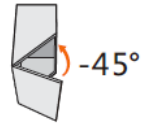

#### Overlay table

#### Three-dimensional adjustment

(F)

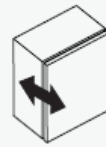
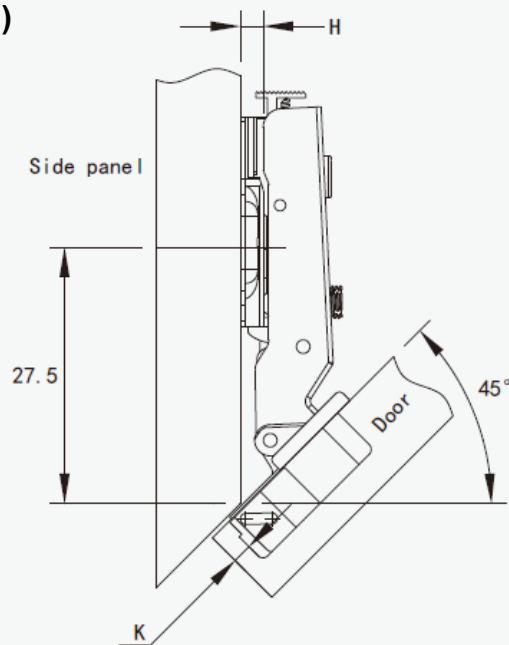

Depth adjustment  
range : 3.8mm

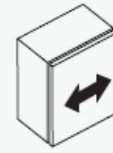

Side adjustment  
range: 5mm

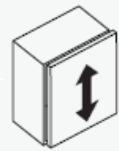

Height adjustment  
range: 3.8mm

#### Application

Side panel-45°

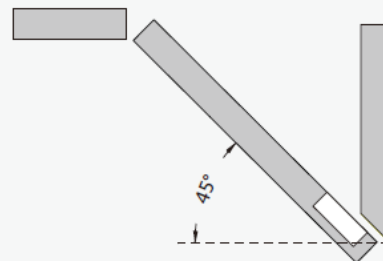
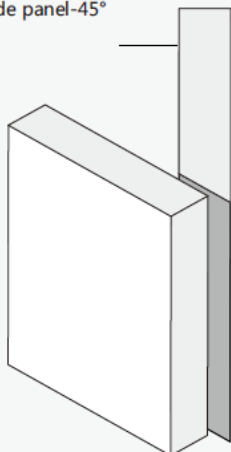

## -45° Bi-fold Clip on hinge

### Order information

#### Drilling hole 45mm CFAY45.1

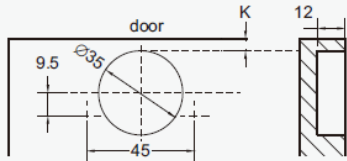

#### Drilling hole 48mm CFAY45.2

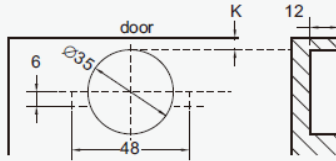

#### Drilling hole 52mm CFAY45.3

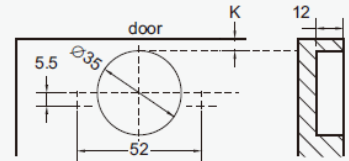

Drilling hole distance	45mm	48mm	52mm
	CFAY45.1. __*	CFAY45.2. __*	CFAY45.3. __*

Notes \*: \_\_ see below cup installation

### Cup installation

#### Screw on

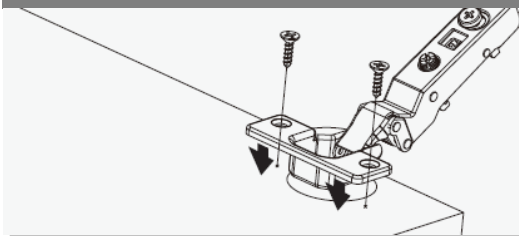

#### Press in

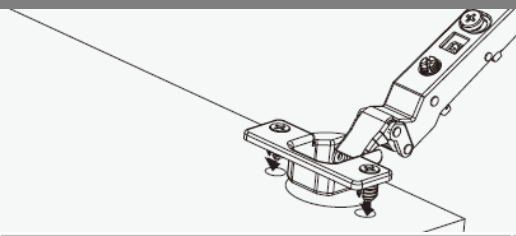

Screw on (wooden screws)	.1	Press in dowels M8	.3
Pre-assembled (ø5mm hole) euro screw	.2	Press in dowels M10	.4

## Mounting plate

### Two holes adjustable mounting plate



- ❑ Drilling distance: 32mm
- ❑ To board edge 37mm
- ❑ Adjustment range  $\pm 1.9$ mm
- ❑ Material : Steel, nickel plated

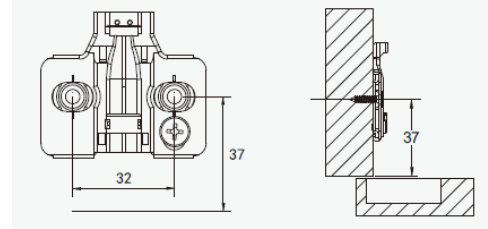

Installation methods	Height		
	H=0	H=2	H=4
For wooden screw $\varnothing 4 \times 15.5$ mm	CP0.1	CP2.1	CP4.1
For holes $\varnothing 5 \times 12$ mm, pre-mounted Euro screw	CP0.2	CP2.2	CP4.2
For holes $\varnothing 5 \times 12$ mm, pre-mounted dowels	CP0.3 __ *	CP2.3 __ *	CP4.3 __ *

Notes \*: \_\_ see below table for different dowels