

# Silent Drawer System



## Modul Box Assembly Instruction

### Special Features:

- Length: 270, 300, 350, 400, 450, 500, 550mm.
- The drawer side-board is 89mm high.
- Drawer width can be designed freely with automatic error adjustment.
- Hidden full pull-out slendro sliding skid can bear 30kg and enjoys excellent stability and quiet and smooth sliding performance.
- Quick installation and dismantle.
- Newly-designed built-in damper is free from reinstallation and ensures soft and smooth drawer movements.

| Basic length | Internally usable drawer depth | Minimum installation depth of drawer | Minimum installation height |
|--------------|--------------------------------|--------------------------------------|-----------------------------|
| 270mm        | 244mm                          | 270mm                                | 160mm                       |
| 300mm        | 274mm                          | 300mm                                | 160mm                       |
| 350mm        | 324mm                          | 350mm                                | 160mm                       |
| 400mm        | 374mm                          | 400mm                                | 160mm                       |
| 450mm        | 424mm                          | 450mm                                | 160mm                       |
| 500mm        | 474mm                          | 500mm                                | 160mm                       |
| 550mm        | 524mm                          | 550mm                                | 160mm                       |

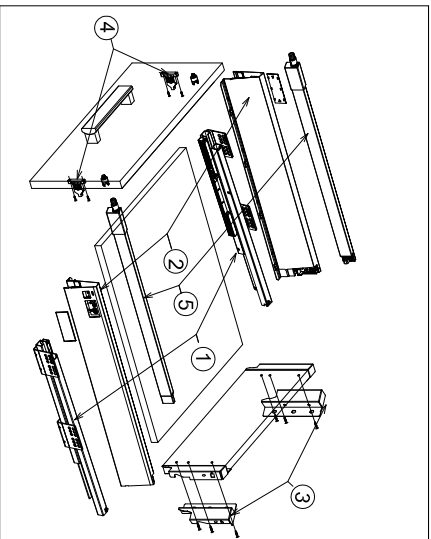

| 1. Guide                        | Left/Right   | Length:   |
|---------------------------------|--------------|---|
|                                 | Left/Right   | 270mm<br>300mm<br>350mm<br>400mm<br>450mm<br>500mm<br>550mm |
| 2. Drawer Side & Decorative Cap | Left/Right   | Length:   |
|                                 | Left/Right   | 270mm<br>300mm<br>350mm<br>400mm<br>450mm<br>500mm<br>550mm |
| 3. Back connector               | Left / Right | 5. Drawrod  |
|                                 | Left / Right | Left / Right  |
| 4. Front connector              | Left / Right |   |
|                                 | Left / Right |   |

### Runner Installation(mm)

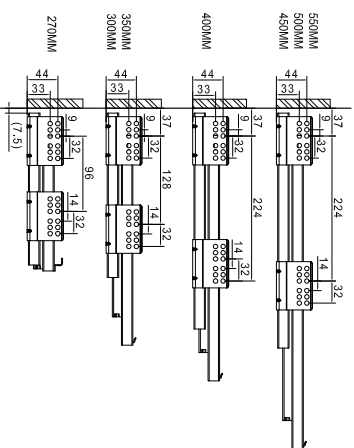

Basic length: 270/300/350/400/450/500/550

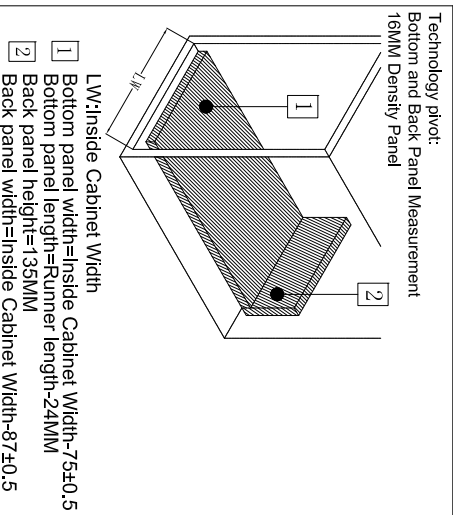

### Inside Cabinet Dimension

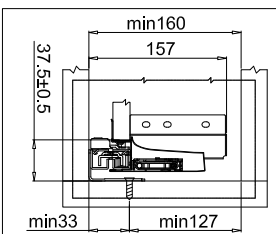

### Front Panel Mounting Positions

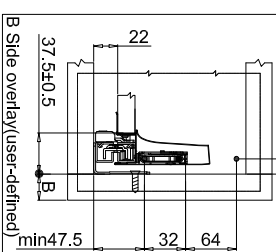

### Front Fixing Brackets Positions

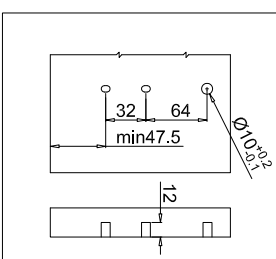

### Back Panel Mounting Positions

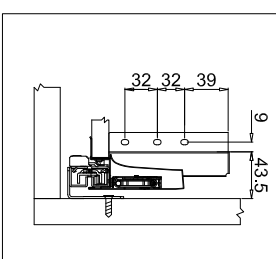

### Front fixing brackets mounting

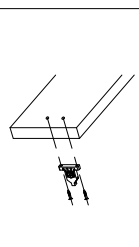

Front panel height adjustment: ±2mm

### Front Panel

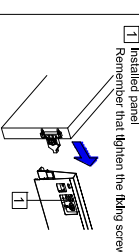

Front panel side adjustment: right trim

### Front panel removing

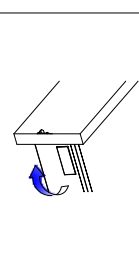

Front panel side adjustment:left trim

### Adjustment the front panel

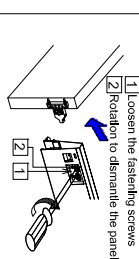

Adjustment the front panel

### Installing the drawer

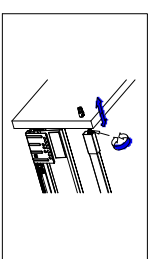
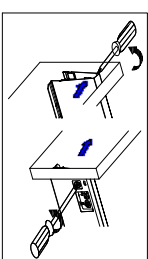
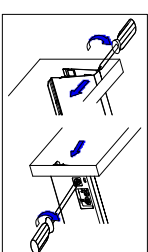
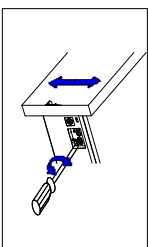

### Mounting the drawer

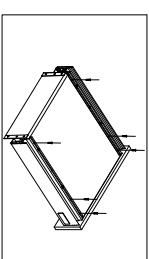
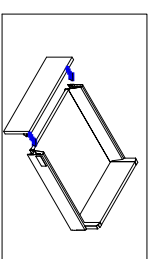
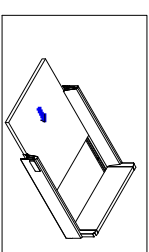
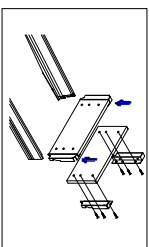

### Installing the drawer

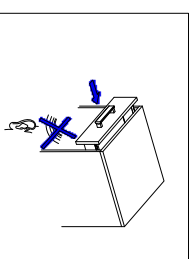
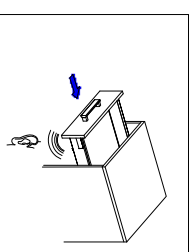
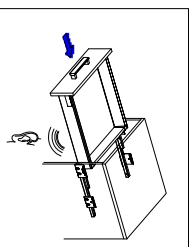
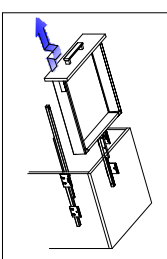
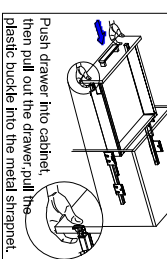
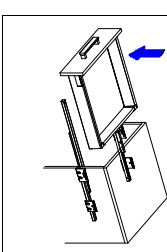
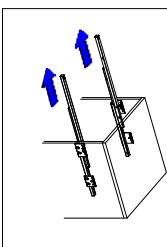
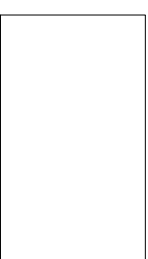
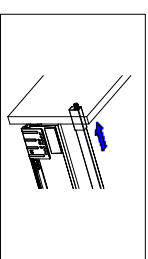
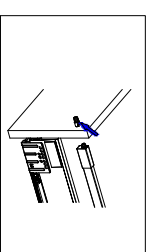
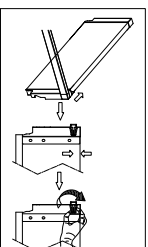

### Removing the drawer

