

Silent Drawer System

Modul Box Assembly Instruction



- Special Features:**
- Length-270,300,350,400,450,500,550mm.
 - The drawer side-board is 89mm high.
 - Drawer width can be designed freely with automatic error adjustment.
 - Hidden full pullout silencing sliding skid can bear 30kg and enjoys excellent stability and quiet and smooth sliding performance.
 - Quick installation and dismantle.
 - Newly-designed built-in damper is free from reinstallation and ensures soft and smooth drawer movements.

Basic length	Internally usable drawer depth	Minimum installation depth of drawer	Minimum installation height
270mm	244mm	270mm	192mm
300mm	274mm	300mm	192mm
350mm	324mm	350mm	192mm
400mm	374mm	400mm	192mm
450mm	424mm	450mm	192mm
500mm	474mm	500mm	192mm
550mm	524mm	550mm	192mm

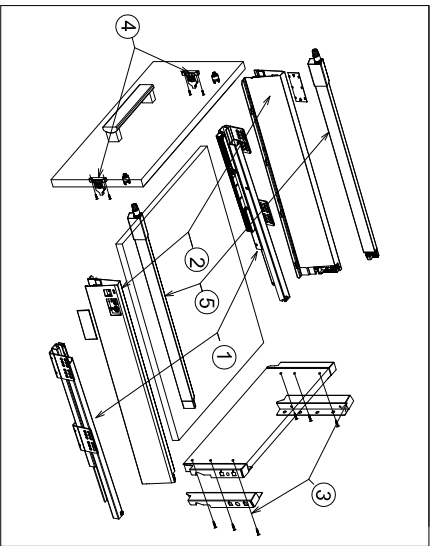

1. Guide	Left/Right	Length:
	Left/Right	270mm 300mm 350mm 400mm 450mm 500mm 550mm
2. Drawer Side & Decorative Cap	Left/Right	Length:
	Left/Right	270mm 300mm 350mm 400mm 450mm 500mm 550mm
3. Back connector	Left / Right	
4. Front connector	Left / Right	
5. Draw-wad	Left / Right	

Runner Installation(mm)

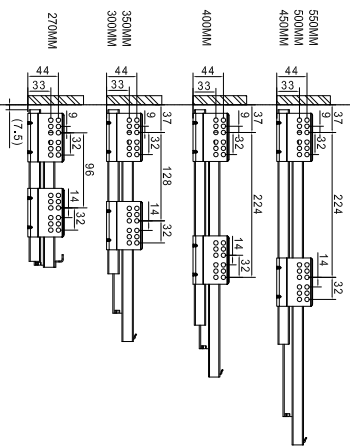

Basic length: 270/300/350/400/450/500/550

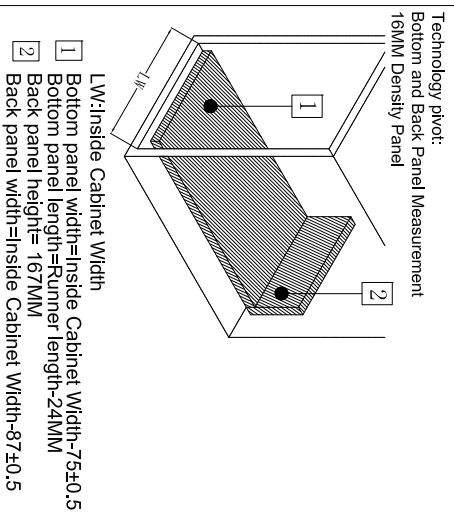

LW:Inside Cabinet Width
 1 Bottom panel width=Inside Cabinet Width-75±0.5
 2 Bottom panel length=Runner length-24MM
 Back panel height= 167MM
 Back panel width=Inside Cabinet Width-87±0.5

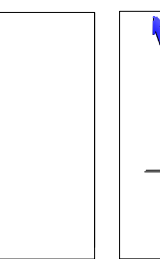
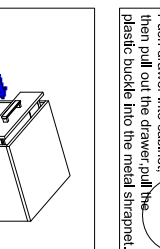
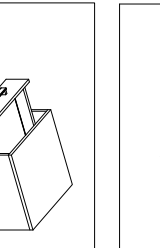
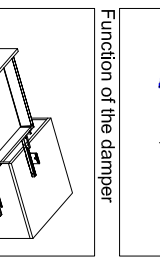
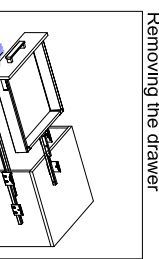
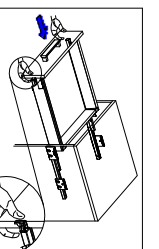
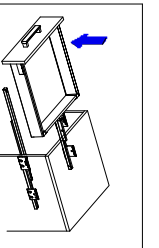
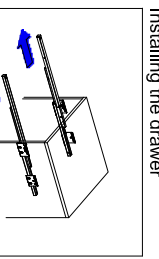
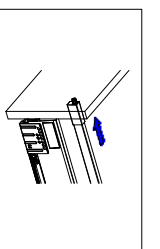
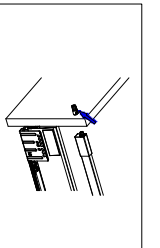
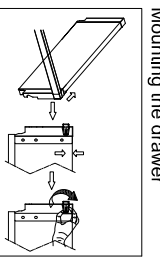
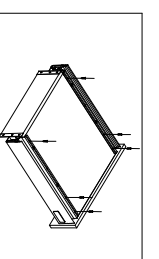
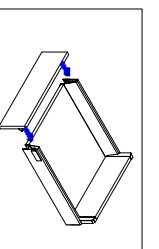
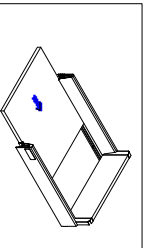
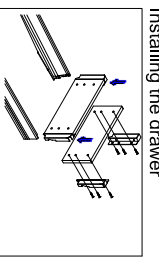
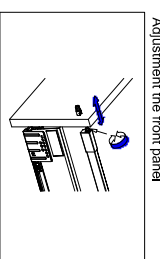
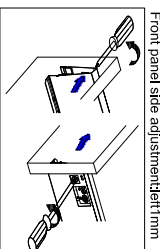
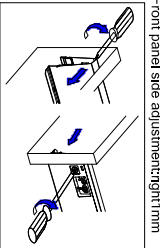
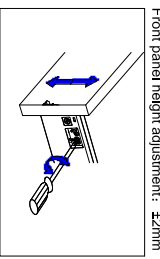
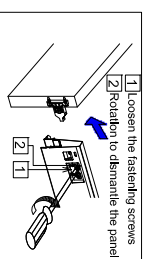
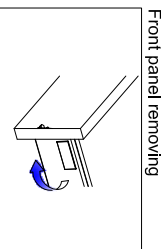
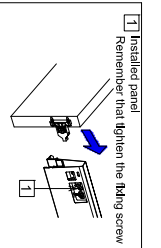
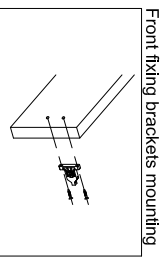
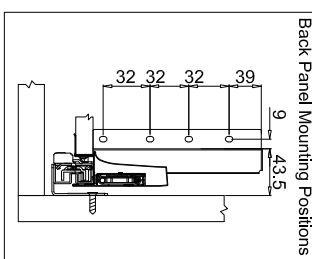
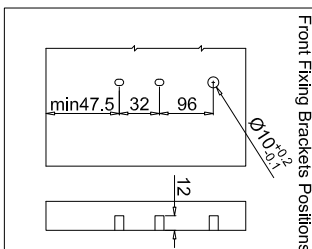
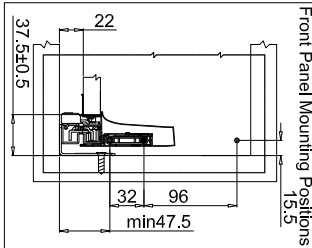
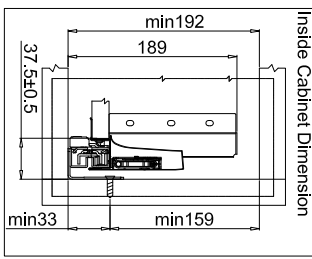

Removing the drawer

